

ENGLISH

ESPAÑOL

FRANÇAIS

ITALIANO

DEUTSCH

PORTUGUÊS

日本語



OWNER'S MANUAL
INSTRUCCIONES DE FUNCIONAMIENTO
MODE D'EMPLOI
ISTRUZIONI OPERATIVE
BEDIENUNGSANLEITUNG
MANUAL DE INSTRUÇÕES
操作方法

Fender[®]
www.fender.com

Important Safety Instructions



- This symbol warns the user of dangerous voltage levels localized within the enclosure of the unit.



- This symbol advises the user to read all accompanying literature for safe operation of the unit.

- Read, retain, and follow all instructions. Heed all warnings.
- Only connect the electric line cord to an earth grounded AC receptacle in accordance with the voltage and frequency ratings listed under INPUT POWER on the rear panel of this product.
- **WARNING:** To prevent damage, fire or shock hazard, do not expose this unit to rain or moisture.
- Unplug the AC power line cord before cleaning the unit exterior (use a damp cloth only). Wait until the unit is completely dry before reconnecting it to power.
- Maintain at least 6 inches of unobstructed air space behind the unit to allow for proper ventilation and cooling of the unit.
- This product should be located away from heat sources such as radiators, heat registers, or other products that produce heat.
- This product may be equipped with a polarized plug (one blade wider than the other). This is a safety feature. If you are unable to insert the plug into the outlet, contact an electrician to replace your obsolete outlet. Do not defeat the safety purpose of this plug.
- Protect the power cord from being pinched or abraded.
- This product should be serviced by qualified service personnel when: the power supply cord or the plug has been damaged; or objects have fallen, or liquid has been spilled onto the product; or the product has been exposed to rain; or the product does not appear to operate normally or exhibits a marked change in

performance; or the product has been dropped, or the enclosure damaged.

- Only use a cart or stand with this product that is recommended by this product's manufacturer.
- The power supply cord of this product should be unplugged from the outlet when left unused for a long period of time, or during electrical storms.
- Do not drip nor splash liquids, nor place liquid filled containers on the unit.
- **CAUTION:** No user serviceable parts inside, refer servicing to qualified personnel only.
- Fender® amplifiers and loudspeaker systems are capable of producing very high sound pressure levels which may cause temporary or permanent hearing damage. Use care when setting and adjusting volume levels during use.

FCC COMPLIANCE NOTICE

This equipment has been tested and found to comply within the limits for a Class B digital device, pursuant to Part 15 of the FCC rules. These limits are designed to provide a reasonable protection against harmful interference in a residential installation. This equipment generates, uses and can radiate radio frequency energy and if not used in accordance with the instructions, may cause harmful interference to radio communications and there is no guarantee that interference will not occur in a particular installation. If this equipment does cause harmful interference to radio or television reception, which can be determined by turning the equipment off and on, the user is encouraged to try to correct the interference by one or more of the following measures: reorient or relocate the receiving antenna, increase the separation between the equipment and receiver, connect the equipment into an outlet on a circuit different from that of the receiver. Consult the dealer or an experienced radio/TV technician if help is needed.

A PRODUCT OF:
FENDER MUSICAL INSTRUMENTS CORPORATION
 CORONA, CALIFORNIA USA

Trademarks:
 Fender®, Blackface™, Dyna-Touch™ and G-DEC™ are trademarks of FMIC,
 other trademarks are property of their respective owners.
 © 2004 FMIC. All rights reserved.

Introduction

G-DEC Guitar Digital Entertainment Center includes everybody in the band but you! Inside G-DEC you will find a versatile drummer, skilled bass player and flexible accompanist for virtually any style of music. And for you, the guitarist: G-DEC is a warehouse of amplifiers and effects, and what's better—these are ready for your sound check!

Turn the G-DEC Data Wheel to access a diverse collection of band setups. 50 permanent presets furnish a diverse collection always available to you. Another 50 rewritable presets store the bands that you create for your music and playing style.

G-DEC is the ultimate practice tool whether you are just starting out or playing professionally. As a beginner, you can have an instructor plug into the

rear input. To learn a new song you can plug your CD or MP3 player into the G-DEC and play along. For difficult licks you can record a phrase and play it in a continuous loop—at *half speed* if necessary! Seasoned players enjoy G-DEC as a songwriting partner or jamming buddy.

G-DEC also has MIDI ports which allow you to link up with other G-DEC players to trade presets. Connect G-DEC to your computer* to backup presets or play General MIDI files through G-DEC!

It's time to jam—with G-DEC at your command!

*MIDI capable sound card (or MIDI-to-USB device) and MIDI software required.

Features

Each G-DEC Preset is a complete "band!" Modify any component or select another from the G-DEC arsenal:

- 17 Guitar Amplifiers, each with Gain, Volume, Tone, Compressor, Timbre and Noise Gate parameters
- 29 studio-quality Effects (many in stereo), each with 4 adjustable parameters
- 10 Reverbs with adjustable levels
- 70 Drum Patterns (+1 Metronome) with Tempo, Key, Drum Level, Bass Level and Accompaniment Level parameters

G-DEC MIDI ports provide expanded functionality with your computer and other G-DEC players!

- Trade and backup presets
- Play MIDI files
- Update G-DEC software if necessary
- Front panel MIDI IN and MIDI OUT ports

G-DEC delivers world-class Fender tone and world-standard Fender quality!

- Second input jack for a friend or instructor
- On-board digital chromatic tuner
- Phones jack can be used with stereo headphones or as a stereo line out jack
- Shoulder strap
- 14-second Phrase Sampler
- On-board General MIDI synthesizer

Thank you for choosing Fender®

—Tone, Tradition and Innovation—since 1946

Control Panel Overview

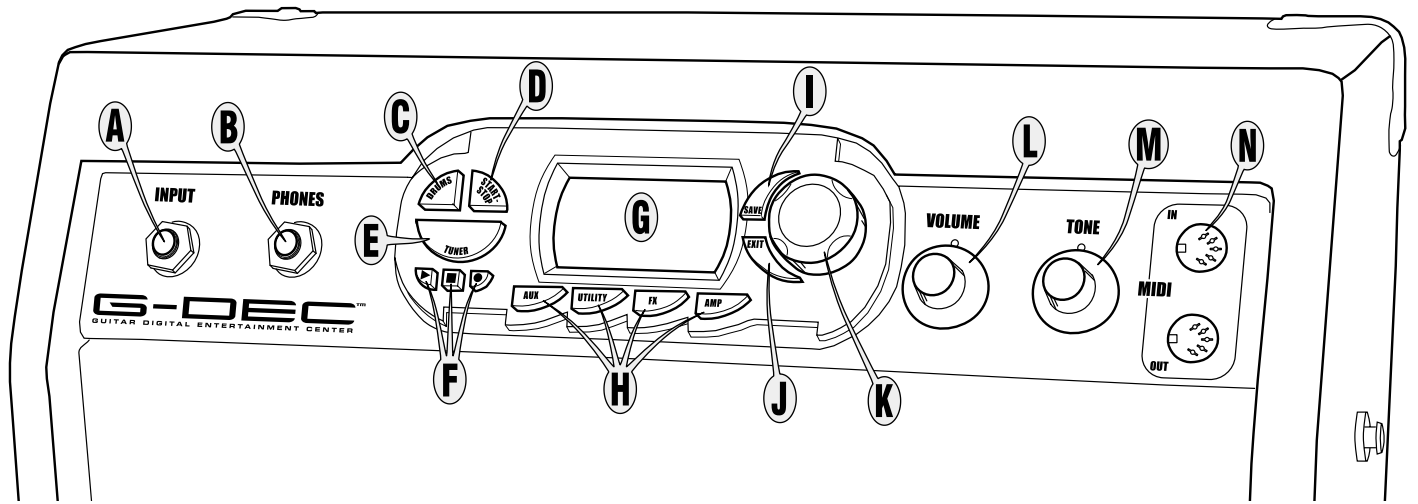

- A. INPUT** - Plug your guitar in here.
- B. PHONES** - Plug in your headphones for private listening or connect a pair of powered speakers (such as commonly used with computers); the G-DEC speaker mutes automatically. Enjoy the G-DEC's many stereo effects through this jack. You can also connect PHONES to "Audio In" on your computer to record with your favorite recording software. **NOTE:** You will need the proper cables, adapters and/or equipment for these connections.
- C. DRUMS** - Press to access the Drums Mode menus (see page 8).
- D. START-STOP** - Press to start and stop the drum loop. The START-STOP button flashes in time with the tempo. You can also use START-STOP to set the tempo:
Shortcut 1—Hold START-STOP while rotating the Data Wheel.
Shortcut 2—Hold DRUMS while tapping START-STOP to the beat, to set the tempo by "feel."
- E. TUNER** - Press to activate the Tuner (the G-DEC speaker mutes automatically).
- F. PHRASE SAMPLER** - Use the Phrase Sampler to record up to 14 seconds of G-DEC audio for playback looping and study. Press:
 ● *Record*—to start sampling
 ▶ *Play*—to playback the phrase
 ■ *Stop*—to end a recording or playback in progress
 Change the recording source, playback speed and other settings through the Auxiliary Mode (see page 8).
- G. DISPLAY** - Shows information about the current preset and menus for adjusting settings in each mode.
- H. AUX / UTILITY / FX / AMP** - Press to access the corresponding mode menus (see pages 7-9).
- I. SAVE** - Saves the current G-DEC settings to a user preset (U00-U49).
- J. EXIT** - Press to return to the Play Mode.
- K. DATA WHEEL** - Selects presets in Play Mode (adjusts settings in the other modes).
- L. VOLUME** - Adjusts the overall loudness of the G-DEC.
- M. TONE** - Adjusts the tone characteristics of your guitar. Tone does not affect the Drum section or the Auxiliary Input sound.
- N. MIDI IN/OUT** - To transfer presets from your G-DEC: Connect MIDI OUT to the MIDI IN on another G-DEC (or your computer) using a MIDI cable. See Utility Mode on page 9, to initiate a "Dump Preset" (to transfer the current preset) or "Dump All" (to transfer all presets). After a "Dump Preset" is initiated, you must select a preset to overwrite on the receiving G-DEC.
- To play General MIDI files on your computer through your G-DEC: Connect MIDI OUT on your properly configured computer sound card (or interface), to MIDI IN on the G-DEC. Then load and play the file in your MIDI playback software on your computer.

Rear Panel

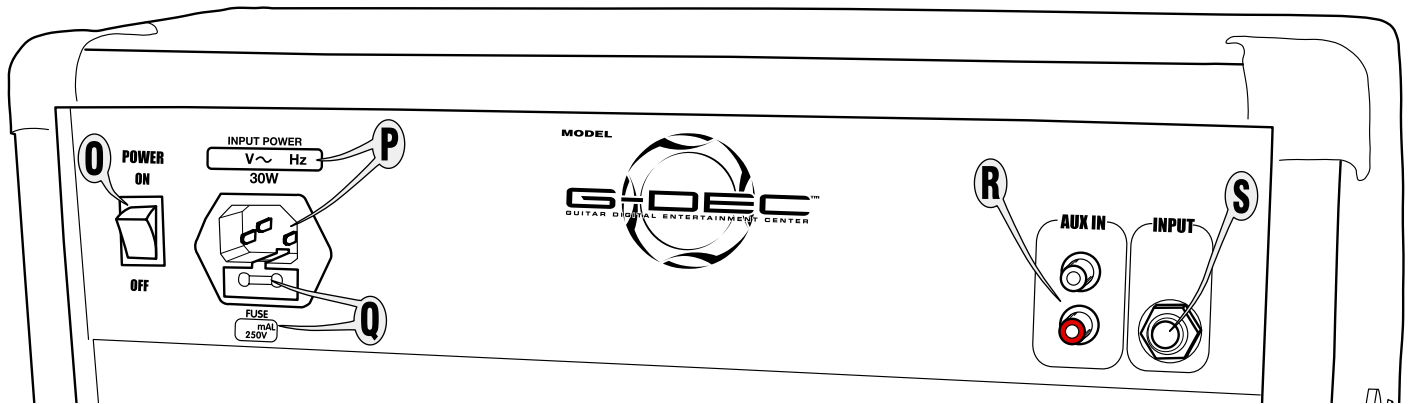

- O. POWER** - Switches the G-DEC on-off.
- P. POWER CORD SOCKET** - Connect your G-DEC to an A/C outlet using the included power cord.
- Q. FUSE** - Protects your G-DEC from electrical faults. Replace a blown fuse *only* with the type and rating specified below the fuse holder. To remove the fuse holder: Unplug the G-DEC power cord from the socket to expose the fuse holder. Use a small screwdriver to pry out the fuse holder using the notch on top.
- R. AUX IN** - Auxiliary input for your CD or MP3 player. Playback music through your G-DEC for accompaniment or to learn songs. Connect the (headphones) output on your player to the AUX IN “RCA” jacks using the proper cable or adapter. You can select a “focus” filter and adjust the auxiliary input level through the Aux Mode menus (see page 8).
- S. INPUT** - An extra input for an instructor or a friend to plug into.

How Do I...?

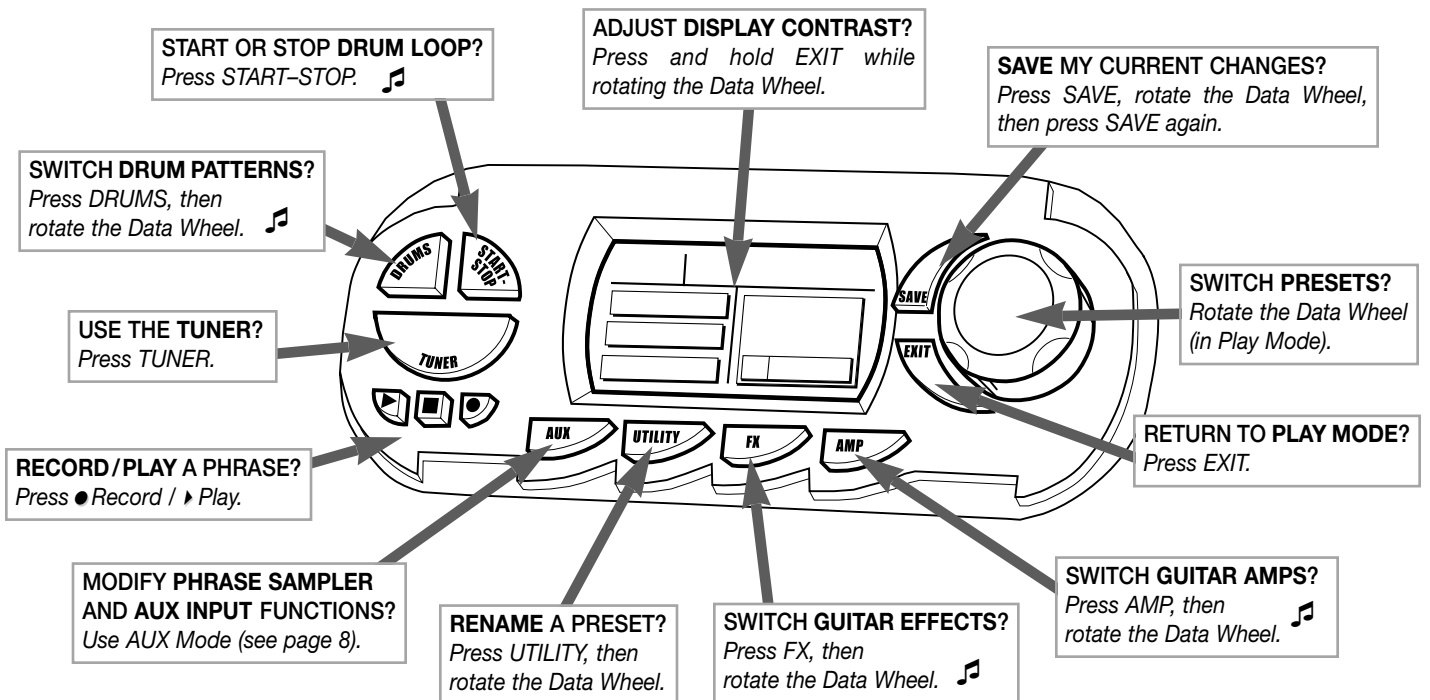

🎵 **Play Mode Shortcut**—Press and hold this button while rotating the Data Wheel to make a quick adjustment without leaving Play Mode.

Play Mode

Play Mode is the normal G-DEC mode, active at start-up. Play guitar, select presets and play the drum loop (or the phrase sampler) in Play Mode. Press EXIT to return to Play Mode at any time (G-DEC defaults to Play Mode after 60 seconds of inactivity in the other modes).

Information about the current preset is displayed in Play Mode:

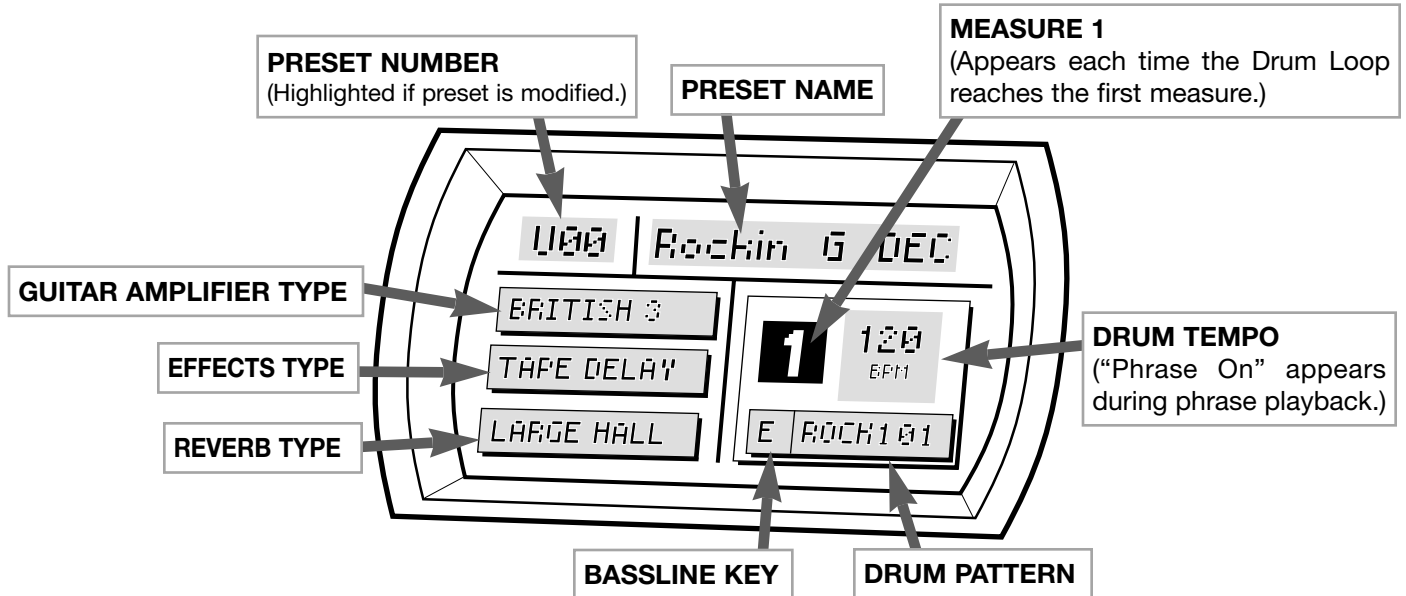

Menu Navigation

You can adjust a huge variety of G-DEC settings through the menus of 5 different modes. Press AMP, FX, DRUMS, AUX or UTILITY (repeatedly) for menus, then turn the Data Wheel to adjust the highlighted menu's setting.

MENU SHORTCUT: First, press AMP, FX, DRUMS, AUX or UTILITY to enter that mode. Then, press and hold the same mode button while rotating the Data Wheel to navigate menus—in both directions!

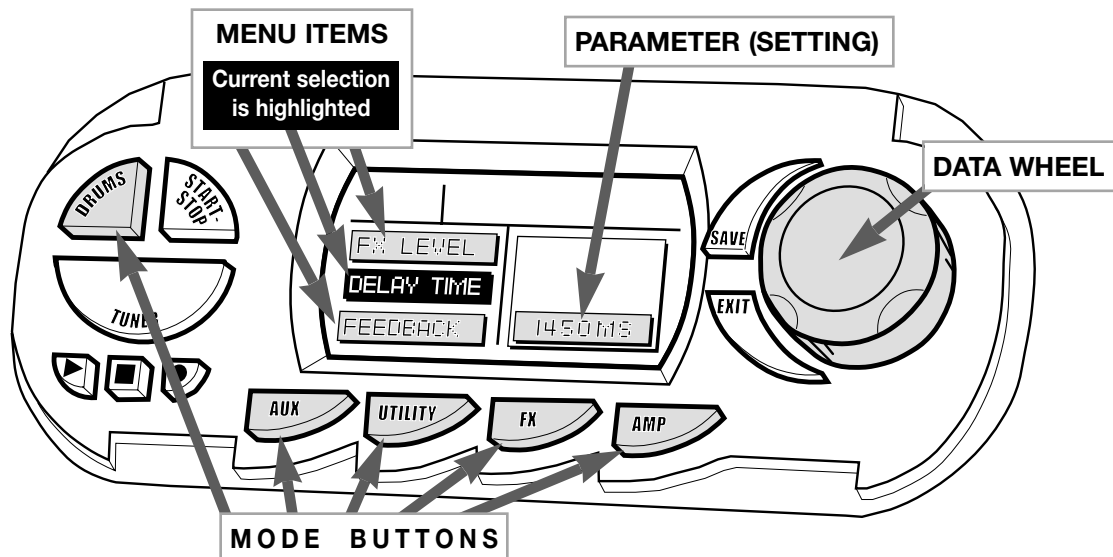

Amp Mode

Use AMP Mode to select an amplifier type (first menu), then modify *that amplifier's* settings (menus 2–9).

Menu	Amp Menu Items	Settings—(Function)
1	AMP TYPE	Tweed–1, 2, 3, Blackface–1, 2, 3, Dyna-Touch–1, 2, 3, 4, British–1, 2, 3, Modern–1, 2, 3, Acoustic
2	GAIN	1-10 — (Adjusts amplifier distortion level.)
3	AMP VOLUME	1-10 — (Adjusts the volume of the current amplifier relative to other presets.)
4	BASS	1-10 — (Low frequency tone.)
5	MIDDLE	1-10 — (Mid-frequency tone.)
6	TREBLE	1-10 — (High-frequency tone.)
7	COMPRESSOR	Off, Low, Medium, High, Super — (Moderates volume range and provides sustain.)
8	TIMBRE	None, Full Body, Full Stack, Razors Edge, Bright Lite, Bass Boost, Nu Metal, Super Bright, Acoustic — (Tone filters.)
9	NOISE GATE	Off, Low, Medium, High, Super — (Cuts low volume noise.)

FX/Reverb Mode

Use FX/Reverb Mode to select a effect type (first menu), then modify *that effect's* settings (menus 2–6).

Effect Type Menu 1	Effect Settings (for the Effect selected in Menu 1)				
	Menu 2	Menu 3	Menu 4	Menu 5	Menu 6
NONE					
MONO DELAY	Level	Delay Time	Feedback	Brightness	Input Level
TAPE DELAY	Level	Delay Time	Feedback	Flutter	Brightness
STEREO TAPE DELAY	Level	Delay Time	Feedback	Flutter	Brightness
DUCKING DELAY	Level	Delay Time	Feedback	Release	Response
REVERSE DELAY	Level	Delay Time	Feedback	Reverse Feedback	Brightness
AUTOPAN DELAY	Level	Delay Time	Feedback	Brightness	Input
SINE CHORUS	Level	Rate	Depth	Average Delay	Stereo
TRIANGLE CHORUS	Level	Rate	Depth	Average Delay	Stereo
SINE FLANGE	Level	Rate	Depth	Feedback	Stereo
TRIANGLE FLANGE	Level	Rate	Depth	Feedback	Stereo
PHASER	Level	Rate	Depth	Feedback	Stereo
TREMOLO	Level	Rate	Depth	Duty Cycle	Release
RING MODULATION DELAY	Level	Ring Mod Frequency	Delay Output Level	Delay Time	Feedback
PITCH SHIFT	Level	Pitch	Detune	Feedback	Pre-Delay
TOUCH WAH	Level	Response	Minimum Frequency	Maximum Frequency	Voice Type
FIXED WAH	Level	Frequency	Minimum Frequency	Maximum Frequency	Voice Type
VIBRATONE	Level	Rotor Speed	Doppler Effect	Depth	Stereo
AUTOSWELL	Level	Attack	Depth	Response	Rate
ALIENATOR	Level	Content	Tone	Minimum Content	Maximum Content
RESOLVER	Level	Bit Depth	Tone	Attack	Release
FUZZ	Level	Gain	Octave Level	Low Tone	High Tone
OVERDRIVE	Level	Gain	Low Tone	Mid Tone	High Tone
TOUCH WAH FUZZ	Level	Gain	Response	Octave Mix	Voice Type
FUZZ DELAY	Level	Gain	Delay Level	Delay Time	Feedback
OVERDRIVE DELAY	Level	Gain	Delay Level	Delay Time	Feedback
CHORUS DELAY	Level	Rate	Depth	Delay Time	Feedback
FLANGE DELAY	Level	Rate	Depth	Delay Time	Feedback
PHASE DELAY	Level	Rate	Depth	Delay Time	Feedback
ALIENATOR DELAY	Level	Content	Delay Level	Delay Time	Feedback

(Continued on next page.)

FX/Reverb Mode (continued)

Use FX/Reverb Mode to select a reverb type (menu 7), then modify *that reverb's* level (menu 8).

Reverb Type Menu 7	Reverb Level Menu 8
NONE	1-10
AMBIENT	1-10
SMALL ROOM	1-10
LARGE ROOM	1-10
SMALL HALL	1-10
LARGE HALL	1-10
ARENA	1-10
SMALL PLATE	1-10
LARGE PLATE	1-10
SPRING	1-10
63 SPRING	1-10

Drums Mode

Use DRUMS Mode to select a drum pattern (first menu), then modify *that drum pattern's* settings (menus 2–6).

Menu	Drum Menu Items	Settings
1	DRUM PATTERN	1 Drop, 16 Hats, 32 Hats, 4 Beat, 5 On 4, 50 Shuf, 80 Funk, 80s Hop, Aerwalk, Ballad, Beastly, Bossa, Chicago, Clave, Classic, Country, Dblkick, Dblshuf, Disco, Dr Hop, Drive, Euro, Fever, Fiesta, Funk, Feelin, Grind, Grunge, Halves, Hardroc, Haze, Hiphop, Jazz, Kid, Latin, Latpony, Levee, Lilith, Mambo, Metal, Metrono, Miami, Party, Pop, Popstar, Punkpop, Reggae, Ride, Rock101, Rocbell, Rocbluz, Rock, Rocker, Salsa, Samba, Shaker, Shuffle, Ska, Smoke, So Bell, Soul, Speed, Steely, Surftom, Swedes, Swing, Train, Trouble, Viking, Waltz, Western
2	TEMPO	30-240 Beats per Minute
3	KEY	A, A#, B, C, C#, D, D#, E, F, F#, G, G#
4	DRUM LEVEL	1-10
5	BASS LEVEL	1-10
6	ACCOMPANIMENT LEVEL	1-10

Auxiliary/Phrase Mode

Use AUX/Phrase Mode to adjust the AUX IN jack settings (menus 1–2).

Use AUX/Phrase Mode to adjust the Phrase Sampler settings (menus 3–7).

Menu	Aux Menu Items	Settings—(Function)
1	AUX INPUT LEVEL	1-10 — (<i>Adjusts the volume of whatever you have connected to the AUX IN jacks.</i>)
2	AUX FILTER	None, Bass Focus, Bass Cut, Drum Focus, Lead Focus, Guitar Cut — (<i>Use to accent different musical areas.</i>)
3	PHRASE LEVEL	1-10 — (<i>Phrase playback level.</i>)
4	PHRASE MODE	Freeform, 4 Beat Lead — (<i>Record with or without a lead in. 4 Beat Lead adjusts measure length for correct timing.</i>)
5	PHRASE SOURCE	Aux In, Drums, Aux In + Drums, Guitar, All — (<i>Select the source(s) that the Phrase Sampler records. NOTE: When set to ALL, start the Drum Loop (press START-STOP) before you press ● Record to include drums in the sample.</i>)
6	PHRASE SPEED	Normal, Half Speed — (<i>Phrase playback speed.</i>)
7	PLAYBACK	Once, Repeat — (<i>Playback the Phrase one time, or in an endless loop.</i>)

Utility Mode

Use UTILITY Mode to rename presets, lock memory, transfer presets (MIDI) and manage the system.

Menu	Utility Menu Items	Procedure—(Function)
1	EDIT PRESET NAME	Rotate Data Wheel, then follow the instructions displayed on screen.
2	MEMORY LOCK	Rotate Data Wheel — <i>(Prevents accidental preset saves and MIDI dumps, but NOT a Factory Reset, see below.)</i>
3	DUMP PRESET	Press SAVE — <i>(Transfers the current preset to another G-DEC or computer connected to the MIDI OUT port.)</i>
4	DUMP ALL	Press SAVE — <i>(Transfers ALL presets to another G-DEC or computer connected to the MIDI OUT port.)</i>
5	FACTORY RESTORE	Press SAVE twice — <i>(Restores every G-DEC setting to the original settings. OVERRIDES MEMORY LOCK.)</i>
6	AMP UPDATE	<i>(Reserved for future G-DEC software updates.)</i>

Specifications

TYPE: PR 520

PART NUMBER:

2350000000 (120V, 60Hz) US	2350000900 (120V, 60Hz) US DS
2350001900 (110V, 60Hz) TW DS	2350003900 (240V, 50Hz) AUS DS
2350004900 (230V, 50Hz) UK DS	2350005900 (220V, 50Hz) ARG DS
2350006900 (230V, 50Hz) EUR DS	2350007900 (100V, 50Hz) JPN DS
2350009900 (220V, 60Hz) ROK DS	

POWER REQUIREMENTS: 50W

POWER OUTPUT: 15W RMS into 8Ω @ 5%THD

POWER AMP INPUT IMPEDANCE: 1MΩ

FUSES: 630mA, 250V for 100/110/120V versions
315mA, 250V for 220V/230V/240V versions

DIMENSIONS

HEIGHT: 15.75 in (40 cm)

WIDTH: 13.75 in (35 cm)

DEPTH: 7.25 in (18.5 cm)

WEIGHT: 16.5 lb (7.4 kg)



Product specifications are subject to change without notice.

