

■ NOTES

- Unplug the instrument when not in use.
- When storing the unit for long periods of time, disconnect the battery.
- You will hear some loss of level and distortion when the battery begins to run down.
- When using external power source, we recommend you use Ibanez AC adaptor AC-109.
- Do not remove the screws on bottom.

■ SPECIFICATIONS

- | | |
|--------------------------|---|
| ● Input Impedance | 500K ohms |
| ● Output Impedance | 10K ohms |
| ● Maximum Output Level | 0 dBm |
| ● Maximum Gain | +30 dB |
| ● Equivalent Input Noise | -100 dBm (IHF-A) |
| ● Power Supply | One 9 Volt Battery
or external AC adaptor (AC-109) |
| ● Size | 125 mm, 4.9"(D) x 70mm, 2.8"
(W) x 52mm, 2"(H) |
| ● Weight | 500g, 1.2 lbs |

OWNERS MANUAL

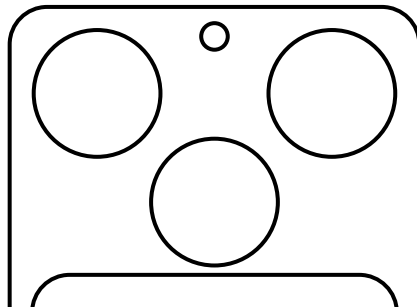

TUBE SCREAMER

Overdrive Pro.

TS-808

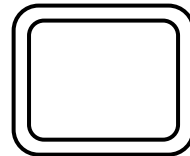

Ibanez

■ FEATURES

- Delivers that warm, natural tube overdrive sound previously unattainable by conventional units.
- FET electronic switching provides clickless, popfree switching.
- Battery can be changed without tools.
- LED indicator shows status of effect and battery condition.
- When using the unit for long periods of time, you can use external AC power by connecting the adaptor to the EXT. POWER jack.
- Zinc die cast construction and rugged rubber stopper assures durability.

■ OPERATION

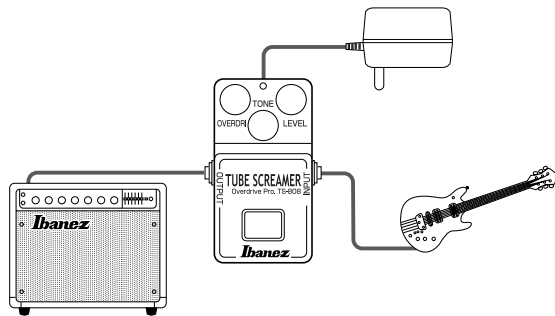

- ① Connect the input jack to your instrument. The circuit is automatically turned on when a plug is inserted.
- ② OVER DRIVE — Adjusts the amount of distortion.
- ③ TONE — Controls the amount of high frequency contour. Adds bite to the sound or makes it mellower.
- ④ LEVEL — Controls the level of the distorted signal, but does not effect the normal signal. Useful for matching the distortion level to the normal level when switching the effect in and out.
- ⑤ Soft touch FET electronic switch changes EFFECT/NORMAL.
- ⑥ LED indicator comes on when effect is on. If it is dim or does not light, replace the battery.
- ⑦ EXT D.C. — When using external D.C. supply, internal batteries are switched off.

■ CHANGING THE BATTERY

- ① Push the tab marked "OPEN" and lift up.
- ② Replace the battery as shown in figure 2.
- ③ Put the battery cover into the groove and push to the end.

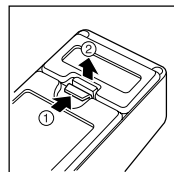

Fig. 1

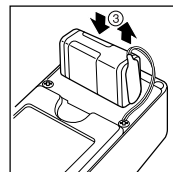

Fig. 2

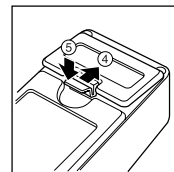

Fig. 3