

B-5RC 2.4GHz Wireless System for Guitar/Bass



FCC ID:2A0AA-B-5RC

© 2019 Cherub Technology-All rights reserved. No part of this publication may be reproduced in any form without prior written permission of Cherub Technology.

www.nuxefx.com Made in China

NUX

WARNING

To reduce the risk of fire or electric shock, do not expose this appliance to rain or moisture.

FCC Warning

This device complies with part 15 of the FCC Rules. Operation is subject to the following two conditions: (1) this device may not cause harmful interference, and (2) this device must accept any interference received, including interference that may cause undesired operation.

Any changes or modifications not expressly approved by the party responsible for compliance could void the user's authority to operate the equipment.

NOTE: This equipment has been tested and found to comply with the limits for a Class B digital device, pursuant to Part 15 of the FCC Rules. These limits are designed to provide reasonable protection against harmful interference in a residential installation. This equipment generates, uses and can radiate radio frequency energy and, if not installed and used in accordance with the instructions, may cause harmful interference to radio communications. However, there is no guarantee that interference will not occur in a particular installation.

If this equipment does cause harmful interference to radio or television reception, which can be determined by turning the equipment off and on, the user is encouraged to try to correct the interference by one or more of the following measures:

- Reorient or relocate the receiving antenna.
- Increase the separation between the equipment and receiver.
- Connect the equipment into an outlet on a circuit different from that to which the receiver is connected.
- Consult the dealer or an experienced radio/TV technician for help.

To maintain compliance with FCC's RF Exposure guidelines, This equipment should be installed and operated with minimum distance between 20cm the radiator your body: Use only the supplied antenna.



The lightning symbol within a triangle means, "Electrical caution!" It indicates the presence of information about operating voltage and potential risks of electrical shock.



The exclamation point within a triangle means, "Caution!" Please read the information next to all caution signs.

System Overview

NUX B-5RC wireless guitar system features with automatic setup, 2.4 GHz interference free broadcasting frequency and 24-bit 44.1 kHz high-quality audio transmitting. The signal latency is super low and less than 5 ms. The operation range is around 15 meters 45-feet). It's a super light-weight wireless, mini compact design that fits all types* of electric guitar, electric-acoustic guitar, bass guitar, and ukulele.

*Tested on 25 variety of different instruments, body types, and brands.

The user-friendly matching system makes it easier to use, just turn ON both wireless units and it will be paired within a couple of seconds. Each wireless set has a unique pairing algorithm, it automatically detects each other and configures their own IDs. The signal never interferes with any other wireless including the WIFI* signal.

*Recommended: Please stay 2 meters (6 feet) away from the WIFI router for the best performance.

NUX B-5RC comes with the power case to keep the wireless unit charged. When the power case is fully charged, it can re-charge the wireless unit's battery 2-3 times.

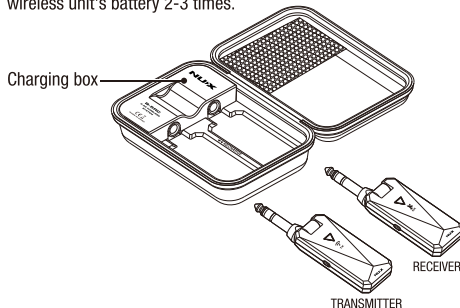

How to operate

-Push and hold the power button to turn ON the transmitter and receiver.
-Before it gets paired automatically, you can see the battery status; if the triangle LED:

- Blinks GREEN – Well Charged (100%~75%).
- Blinks YELLOW –Medium Battery (75%~50%).
- Blinks RED – Lower Battery (50%~25%).
- Flashing RED for 10 times – Low Battery (<25%) , turn off automatically to protect battery life.

▼ LED  Battery (100%~75%)

▼ LED  Battery (75%~50%)

▼ LED  Battery (50%~25%)

▼ LED  Battery (<25%)

* Regularly B-5RC could work around 3.5 hrs since full-charged to low battery.

-After 2 seconds, it will be paired automatically, and the receiver triangle LED status will flash GREEN.

* (B-5RC will detect the best channel in 2.4GHz frequency band, if the transmitter and receiver get paired, both will show GREEN. If the receiver doesn't receive signal, receiver's LED will flash RED. Since the receiver receives the signal, it will show GREEN.)

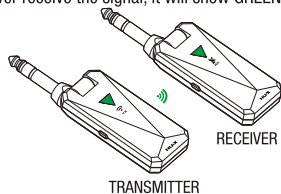

How to operate

-Connect the transmitter to your instrument output, and connect the receiver to the unit where you want to send the signal (amplifier, pedal, audio interface or mixer, etc.)

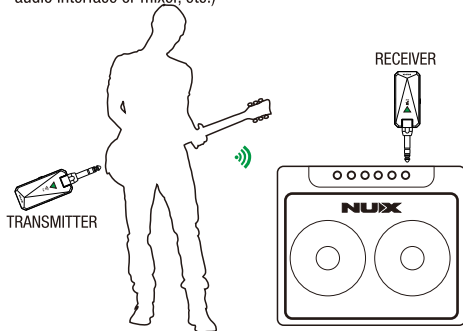

Please turn off the unit (both the transmitter and the receiver,) and put them back to the power case each time after you use it. If the unit's battery is running low, you can press the power button on the power case to activate its charging function. Once the unit is fully charged, the charging function will be shut down automatically. Do remember to recharge the power case once you noticed that there is only 1 indicator light on (low capacity indicator).

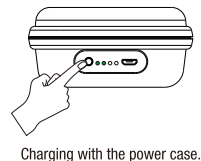
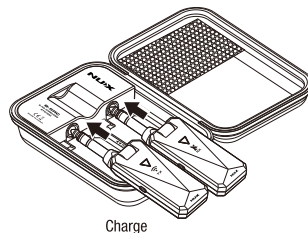

How to operate

NOTICE: To recharge the power case, please make sure that your power adapter has a power output of 5V and 1A (or higher).

-You can charge the wireless units directly by using the micro-B USB Y cable (included)

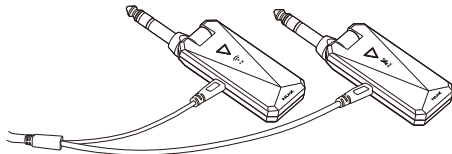

NOTICE: ID MATCH-B-5RC already sets ID matched before shipping, but if you want to use different transmitter or receiver to get paired, please follow the steps to re-set ID match. Turn off the devices, hold the power button of transmitter and receiver for more than 5 seconds, then it will enter to ID match status. Since the receiver blink from RED to GREEN, it finishes ID match.

Function Introduction

Mute function

-While B-5RC works, press transmitter's power button once, it will enter to MUTE, then the transmitter and receiver will show RED.

-Press transmitter's power button again, it will go back to work status. The transmitter and receiver will show GREEN.

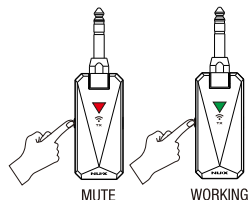

Cabletone function

While B-5RC works, press receiver's power button, the receiver will enter to Cabletone mode.(Receiver's LED indicator will become "Orange".) It simulates around 21 feet (6.4 meters) length cable capacitor effect. (The default is "Regular" mode, if you need Cabletone, please operate the process manually.)

Audio Precision

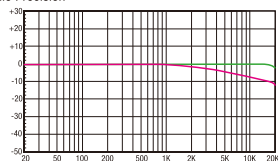

Sweep	Trace	Color	Line Style	Thick	Data	Axis	Comment
3	1	Green	Solid	3	Avir_Ampl	Left	Regular
4	1	Magents	Solid	3	Avir_Ampl	Left	Cabletone

Auto Off function

If there is no signal till 10 minutes, B-5RC will turn off automatically to save battery power.

NOTE: While you are charging with USB port, B-5RC will stop working, and go to battery charging. LED shows RED as charging, while it's full charged RED LED will turn off.

Specifications

- 2.4 GHz operating frequency
- 24bit 44.1 kHz audio quality
- Low latency signal transmitting, less than < 5ms
- Frequency response 20Hz – 20kHz
- THD+ Noise <0.05% 1kHz @ -10dbFS
- Auto-sleep mode
- Transmitter and receiver: 3.7V/500 mAh
- Battery run time 3.5 hours (approx)
- Power case: 4000 mAh
- Both wireless units can be charged 3+ times
- Dimensions: 107(L)x25(W)x26(H)mm
- Weight: 68g

*Specifications and appearance subject to change without notice.